

Mischer LB404/484

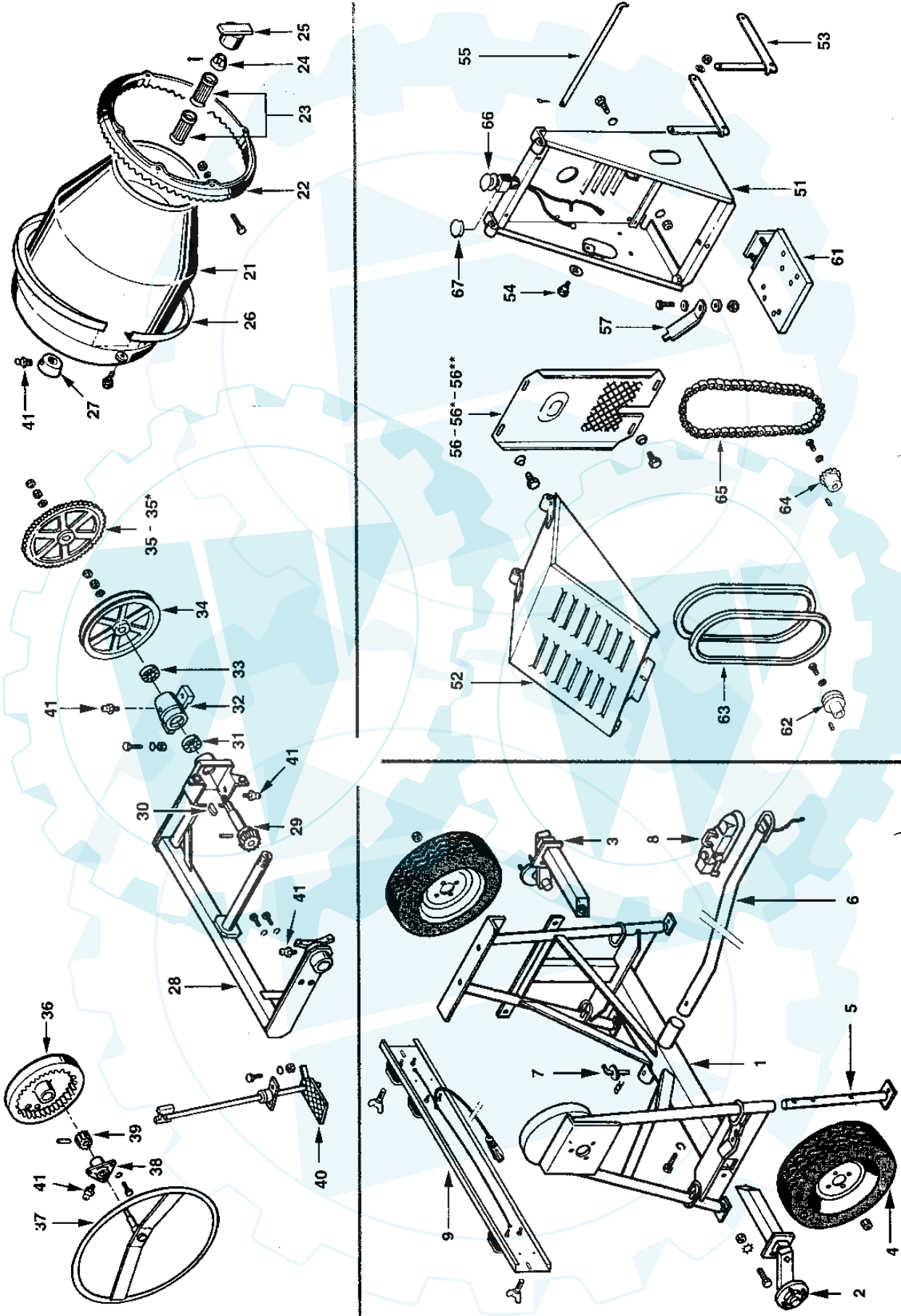

| Rep | Qté | B 406 | B 486 | Désignation | Signation |
|-----|-----|-----------|-----------|---------------------------|-------------------------|
| 1 | 1 | 291100 | 301100 | Chassis | Frame |
| 2 | 1 | 271121 | 271121 | Demi essieu droit | Right axle |
| 3 | 1 | 271122 | 271122 | Demi essieu gauche | Left axle |
| 4 | 2 | 271097 | 271097 | Roue 135 x 13 | Wheel 135 x 13 |
| 5 | 4 | 271061 | 271061 | Pied télescopique | Telescopic foot |
| 6 | 1 | 381102 | 381102 | Timon | Draw bar |
| 7 | 1< | 261104 | 261104 | Broche | Drift |
| | 5< | 009840 | 009840 | Goupille B 2,9 | Split Pin B 2,9 |
| 8 | 1 | LZ020 | LZ020 | Option crochet boule ø 50 | Option towing ball ø 50 |
| 9 | 1 | 397650 | 397650 | Plaque de signalisation | Signals Metal plate |
| | 2 | 009303 | 009303 | Vis papillon 10 x 20 | Screw 10 x 20 |
| 21 | 1 | 292100 | 302100 | Cuve | Mixing drum |
| 22 | 1 | 000145 | 000146 | Couronne | Slewing ring |
| | 8 | H 10 35 | H 10 35 | Boulon | Bolt |
| | 10 | MN12 | LN20 | Rondelle | Washer |
| 23 | 2< | 042011 | 302014 | Roulement | Ball bearing |
| 24 | 1 | 272006 | 302007 | Ecrou à créneaux | Nut |
| 25 | 1 | 272007 | 272007 | Bouchon | Plug |
| 26 | 2 | 292105 | 302105 | Demi protecteur | 1/2 protection |
| | 4 | | | Vis zinguée H 10 20 | Screw |
| | 4 | | | Rondelle JZC M10 zinguée | Washer JZC M10 |
| 27 | 1< | 292108 | 302102 | Entretien de cuve | Washer |
| 28 | 1 | 397000 | 396060 | Etrier | Bracket |
| 29 | 1< | 293100 | 303038 | Axe d'entraînement | Pin |
| 30 | 1< | | | Clequette B x 7 x 40 | Key B x 7 x 40 |
| 31 | 1< | 000915 | 000915 | Roulement 32206 | Ball bearing 32206 |
| 32 | 1 | 323002 | 323002 | Pailier | Bearing |
| 33 | 1< | 000911 | 000911 | Roulement 30206 | Ball bearing 30206 |
| | 2 | H 14 x 40 | H 14 x 40 | Boulon | Bolt |
| | 2 | AZ 14 | AZ 14 | Rondelle | Washer |
| 34 | 1 | 273056 | 273056 | Poulie | Pulley |
| | 2 | HM 16 | HM 16 | Ecrou | Nut |
| | 1 | LU 16 | LU 16 | Rondelle | Washer |
| 35 | 1< | 013007 | 013007 | Roue 95 dents | Chain wheel 95 teeth |
| 35* | 1< | 023055 | 023055 | Roue 72 dents | Chain wheel 72 teeth |
| 36 | 1 | 293050 | 293050 | Secteur de basculement | Tilting sector |
| | 2 | H10 20 | H10 20 | Vis | Screw |
| | 2 | W 10 | W 10 | Rondelle | Washer |
| 37 | 1 | 293120 | 293120 | Volant | Steering wheel |
| 38 | 1 | 273043 | 273043 | Palier volant | Bearing |
| | 3 | H10 35 | H10 35 | Vis | Screw |
| 39 | 1< | JZC M10 | JZC M10 | Rondelle | Washer |
| | 1< | 293118 | 293118 | Pignon | Pinion |
| | 1< | E10 45 | E10 45 | Goupille | Mecanidius pin |
| 40 | 1 | 293051 | 293051 | Système blocage | Locking system |
| | 2 | H10 25 | H10 25 | Boulon | Bolt |
| | 2 | AZ 10 | AZ 10 | Rondelle | Washer |

| Rep | Qté | B 40F | B 486 | Désignation |
|------|-----|--------|--------|--------------------------|
| 41 | 5< | 009960 | 009960 | Graisseur 10 x 150 |
| | 1 | 274036 | 274036 | Fond de capot |
| | 1 | 274043 | 274043 | Porte |
| 52 | 2 | 324032 | 324032 | Support capot |
| 53 | 6 | 324006 | 324006 | Vis épaulée |
| 54 | 1 | 274037 | 274037 | Broche |
| 55 | 1 | 274108 | 274108 | Protection standard |
| 56 | 1 | 274109 | 274109 | Protection Moteur Robin |
| 56* | 1 | 274110 | 274110 | Protection Moteur Diesel |
| 56** | 1 | 304102 | 304102 | Cale d'ouverture |
| 57 | 1 | | | Wedge |

| Moteur essence/Petrol engine Honda G 200 | | | | Moteur essence/Petrol engine Robin EH 17 DU | | | |
|---|---|------------|------------------------------|--|---|------------|------------------------------|
| 61 | 1 | 274162 | Support/Support | 61 | 1 | 274162 | Support/Support |
| 62 | 1 | 274079 | Poulie/Pulley | 62 | 1 | 274079 | Poulie/Pulley |
| 63 | 2 | A55-274047 | Courroie/Belt | 63 | 2 | A55-294123 | Courrois/Belt |
| 66 | 1 | 294133 | Arrêt d'urgence/Urgency stop | 66 | 1 | 294133 | Arrêt d'urgence/Urgency stop |
| Moteur essence/Petrol engine Honda GX 120 LX | | | | Moteur essence/Petrol engine Robin EH 17 B | | | |
| 61 | 1 | 274162 | Support/Support | 61 | 1 | 274162 | Support/Support |
| 62 | 1 | 274054 | Poulie/Pulley | 62 | 1 | 397580 | Poulie/Pulley |
| 63 | 2 | A57-274045 | Courroie/Belt | 63 | 2 | A56-294123 | Courrois/Belt |
| 64 | 1 | 324027 | Pignon 15 d/Pinion 15 d | 64 | 1 | 034018 | Pignon 12 d/Pinion 12 d |
| 65 | 1 | 154008 | Chaîne 114 m/Chain 114 m | 65 | 1 | 154008 | Chaîne 114 m/Chain 114 m |
| 66 | 1 | 294133 | Arrêt d'urgence/Urgency stop | 66 | 1 | 294133 | Arrêt d'urgence/Urgency stop |
| Moteur essence/Petrol engine Honda GX 180 LX | | | | Moteur diesel/Diesel engine Robin DY23B | | | |
| 61 | 1 | 274162 | Support/Support | 61 | 1 | 294005 | Support/Support |
| 62 | 1 | 274055 | Poulie/Pulley | 64 | 1 | 034018 | Pignon 12 d/Pinion 12 d |
| 63 | 2 | A57-274045 | Courroie/Belt | 65 | 1 | 294006 | Chaîne 92 m/Chain 92 m |
| 64 | 1 | 034018 | Pignon 12 d/Pinion 12 d | 67 | 1 | 007022 | Bouchon/Plug |
| 65 | 1 | 154008 | Chaîne 114 m/Chain 114 m | | | | |
| 66 | 1 | 294133 | Arrêt d'urgence/Urgency stop | | | | |
| Moteur essence/Petrol engine Briggs & Str. 5 ch | | | | Moteur Electrique/Electric motor Mono 1,5 kW | | | |
| 61 | 1 | 274162 | Support/Support | 61 | 1 | 274048 | Support/Support |
| 62 | 1 | 274079 | Poulie/Pulley | 62 | 1 | 274153 | Poulie/Pulley |
| 63 | 2 | A56-294123 | Courroie/Belt | 63 | 2 | A57-274045 | Courrois/Belt |
| 64 | 1 | 324020 | Pignon 10 d/Pinion 10 d | 64 | 1 | 324019 | Pignon 17 d/Pinion 17 d |
| 65 | 1 | 154008 | Chaîne 114 m/Chain 114 m | 65 | 1 | 154008 | Chaîne 114 m/Chain 114 m |
| 66 | 1 | 294133 | Arrêt d'urgence/Urgency stop | 67 | 1 | 007022 | Bouchon/Plug |